

AIR AID®

INTAKE SYSTEMS

Installation Instructions
Part Number 200-168
2005 Chevrolet Silverado HD 6.0L & 8.1L
2006 Chevrolet Silverado
2007 Silverado "Classic"
4.3L, 4.8L, 5.3L, 6.0L, 8.1L
(Does not fit GMC truck)



Packing List:

#1	700-469	Airaid Premium Filter	1
#2	KIT167RRC	Rear Air Dam Coated	1
#3	KIT167MAFC	MAF Panel Coated	1
#4	KIT1121MAFADA	Filter Adapter	1
#5	KITWSTRIP02	Weather Strip 21"	1
	KIT168HP	Hardware & Instructions	1
#6	KIT6C31MXPPZ	6-32x 5/16" Screw	5
#7	KIT6NWSAPZ	#6 Flat Washer	5
#8	KIT6CNKEPZ	6-32 Keps Nut	5
#9	KIT15DHC3050	1/4-20 x 1/2" Button Head Bolt	3
#10	KIT09FWZ019	1/4" Flat Washer	7
#11	KIT60C250HCS	M6-1x25 Hex Bolt	4
#12	KITX1011	7 1/4" Rubber Trim	1

Tools Required For Installation:

Flat Head & Phillips Screwdriver
 10mm Socket or Wrench
 Ratchet & Extension
 5/32" Allen Wrench



1. Disconnect the negative battery cable. Loosen the 2 hose clamps located at the Mass Air Flow (MAF) meter.

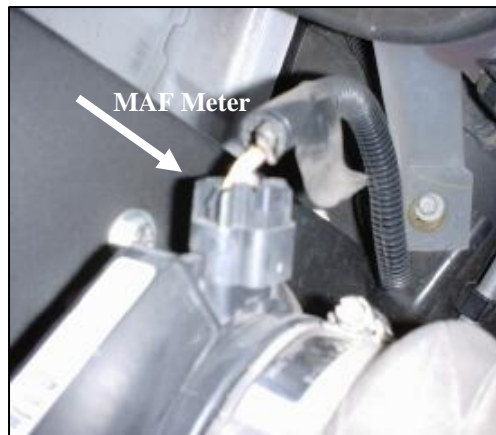

2. Disconnect the MAF meter wiring harness, and remove the meter from the factory intake tube.



3. Remove the factory air filter lid, intake tube, and base from the vehicle as an assembly. (Hint: pull straight up on the air filter base to remove, there are no bolts, just grommets).



4. Using a 10mm socket, remove the five bolts that secure the factory air filter housing platform and remove it.

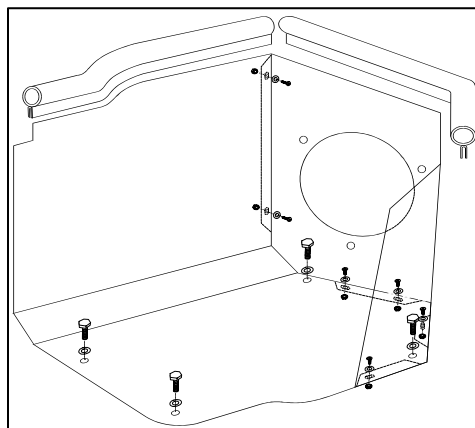

5. Assemble the Airaid Cool Air Dam panels (#2, #3) using five 6-32x 5/16" screws (#6), #6 flat washers (#7) and 6-32 keps nuts (#8).



6. Install the 7 1/4" rubber trim (#12) onto the side of the Airaid Cool Air Dam.



7. Install the filter adapter (#4) using three 1/4-20 x 1/2" button head bolts (#9) and 1/4" flat washers (#10).

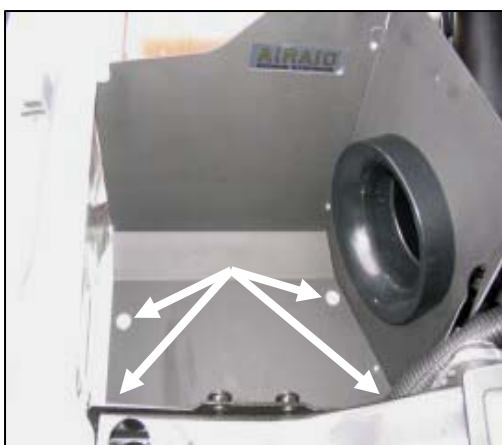

8. Position the Airaid Cool Air Dam in place of the factory air box. Secure it to the factory mounting pad using four M6-1x25 bolts (#11) and 1/4" flat washers (#10). (*Caution:* over tightening may distort the cool air dam!)



9. Slide the factory MAF meter onto the filter adapter. Tighten the hose clamp. (*Note:* The factory clamp / rubber bushing must be in place on the inlet to the MAF meter.) Reconnect the factory intake tube, MAF meter wiring harness, and tighten the clamps.



10. Mount the Airaid Premium Filter (#1) onto the filter adapter and tighten the hose clamp. Press the weather strip (#5) along the top edges of the Airaid cool air dam, assure that it is fully seated along the edges. (Hint: *Begin at a corner and work toward the ends.*)

11. Double check your work!

Make sure there is no foreign material in the intake path. Make sure all clamps, hoses, bolts, and screws are tight.

12. Reconnect the negative battery cable!

Included with your Airaid Intake System is a sticker with a California Air Resources Board (C.A.R.B.) Executive Order (EO) number. This sticker must be placed in plain view inside of the engine compartment. Failure to do so may prevent you from passing a smog inspection.

Before!



After!



Thank you for purchasing the Airaid Intake System. Contact Airaid @ (800) 498-6951 8:00 AM - 5:00 PM MST weekdays for questions regarding fit or instructions that are not clear to you. Your Airaid Intake System was carefully inspected and packaged. Check that no parts are missing, or were damaged during shipping. If any parts are missing, contact Airaid. The air filter element is protected from direct exposure to water and debris; care should be taken not to drive through deep water. WATER INGESTION IS THE DRIVERS RESPONSIBILITY! The air filter is reusable and should be cleaned using the Airaid Filter Tune-Up Kit periodically.

Don't Forget Your AIRAID Filter Tune-Up Kit!



P/N 790-551 Aerosol Spray
P/N 790-550 Squeeze Spray

Instructions Revision
 Date: 11/07/07